

***Temtop***

**T1 SE**  
**Hygrometer Thermometer**  
**User Manual**

## Get More Information

Scan the QR code for multi-language manuals and more.



Scan for multi-language manuals and more product support.

Scannen Sie nach mehrsprachigen Handbüchern und mehr Produktsupport.

Numérisez pour obtenir des manuels multilingues et plus d'assistance sur les produits.

Scansione per manuali multilingue e maggiore supporto al prodotto.

Busque manuales en varios idiomas y más asistencia sobre productos.

## Temperature And Humidity Effects



Temperature & Humidity may often be ignored however they do have a significant impact on individual's well-being, comfort, health and safety as well as your property. High humidity may lead to an increase in household air pollutants especially the biological contaminants such as molds, bacteria, viruses and dust mites; cold, low humidity may cause nosebleeds, skin and respiratory irritations, dyspnea, static electricity and etc.

### Important

- ★ Do not use the detector for a long time in high temperature, high humidity, strong magnetism or dusty environment to ensure accurate measurement.
- ★ Children should only use this device under adult supervision. Keep packaging materials, such as plastic bags and plastic wrap, out of the reach of children as they present a choking hazard.
- ★ Do not dismantle the unit yourself. In the event of a defect, contact your dealer instead, who will liaise with the service center and, if necessary, send the device in for repair.
- ★ This product is intended to be used as a healthy living reference and not as a measuring device!

## Overview

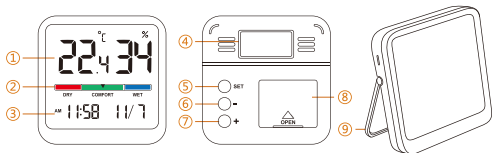

- |   |                 |                       |
|---|-----------------|-----------------------|
| ① Temperature & humidity                  | ② Comfort level |                       |
| ③ Time*, year, month and day display area |                 |                       |
| ④ Magnetic and 3M sticker area            | ⑤ SET button    |                       |
| ⑥ - button                                | ⑦ + button      | ⑧ Battery compartment |
| ⑨ Bracket                                 |                 |                       |

\* The time can be switched to 12-hour or 24-hour.

## Specifications

Model	T1 SE
Temperature*	Measuring range: -10-50°C (14-122°F) Resolution: 0.1°C (0.1°F), Accuracy: ±1°C (±1.8°F)
Humidity*	Measuring range: 10-95% RH Resolution: 1% RH, Accuracy: ±5% RH (40%RH-80%RH), ±8%RH (Others)
Time and date	Time display: switchable between 12-/24-hour mode Time accuracy: +2 second / day.
Comfort indicator	Dry, Comfortable, Humid
Test frequency	Every 10 seconds
Batteries	1 CR2032 (3V) battery
Battery life	1 year
Accessories /fixing	Built-in strong magnet, 3M sticker with metal.
Dimension	70*70*14.7mm / 2.76*2.76*0.579 (inches)
Weight	About 57g







- \* When the temperature is below -10°C, LL.L°C is displayed;
- When the temperature is above 50°C, HH.H°C is displayed.
- When the humidity is below 10%, L% is displayed;
- When it is above 95%, HH% is displayed.

## Button & Operation

### Before use:

Please remove the insulation from the battery compartment. Open the battery compartment, insert a new CR2032 (3V) battery, and close the battery compartment. Segments of the LCD screen will be fully displayed for 2 seconds and then they will display the current room temperature and humidity, the default time of 12:00 (in 24-hour format by default) and the date of 1st January 2022.

Button , - and 

Press and hold the  button for 3 seconds. The hour digits will start flashing. Press  or  to adjust the value or press and hold  or  to adjust it quickly. Then press  to confirm the selection and move on to the next setting item. The setting sequence is as follows: hour->minute->year -> month ->date ->exit. If no operation is performed within 30 seconds, the device switches off and automatically saves the setting values.

Press  to switch between 12- and 24-hour time display mode.

Press  to switch between °C and °F.

# Colour Bar Grade Reference

Comfort indicator:



DRY

Red represents DRY  
( $< 40\%$ )



COMFORT

Green represents COMFORT  
( $40\% \sim 69\%$ )



WET

Blue represents WET  
( $70\% \sim 95\%$ )

## Battery Warning Statement

- a) The statement "Remove and immediately recycle or dispose of used batteries according to local regulations and keep away from children. Do NOT dispose of batteries in household trash or incinerate."
- b) The statement "Even used batteries may cause severe injury or death."
- c) The statement "Call a local poison control center for treatment information."
- d) A statement indicating the compatible battery type (CR2032).
- e) A statement indicating the nominal battery voltage (3V).
- f) The statement "Non-rechargeable batteries are not to be recharged."
- g) The statement "Do not force discharge, recharge, disassemble, heat above (manufacturer's specified temperature rating 50°C) or incinerate. Doing so may result in injury due to venting, leakage or explosion resulting in chemical burns."
- h) The statement "Ensure the batteries are installed correctly according to polarity (+ and -)."



- i) The statement “Do not mix old and new batteries, different brands or types of batteries, such as alkaline, carbon-zinc, or rechargeable batteries.”
- j) The statement “Remove and immediately recycle or dispose of batteries from equipment not used for an extended period of time according to local regulations.”
- k) The statement “Always completely secure the battery compartment. If the battery compartment does not close securely, stop using the product, remove the batteries, and keep them away from children.”

## WARNING

- **INGESTION HAZARD:** This product contains a button cell or coin battery.
- **DEATH** or serious injury can occur if ingested.
- A swallowed button cell or coin battery can cause **Internal Chemical Burns** in as little as **2 hours**.
- **KEEP** new and used batteries **OUT OF REACH of CHILDREN**
- **Seek immediate medical attention** if a battery is suspected to be swallowed or inserted inside any part of the body.



## What's Included

- Hygrometer Thermometer x 1
- User Manual x 1
- 3M Adhesive Sticker (with Iron Sheet) x 1

## Warranty

Temtop warrants the included detector for 1 year from the date of original purchase. The item can be exchanged or returned within 30 days if the defect is not caused by artificial damage.

Item	Warranty Period
Detector	1 year
Accessories	N/A

Before return or delivery for repair, please check if the following ✓ items are ready:

	Detector & Accessories	Complete package	Proof of purchase*	Gift(if any)
Return	✓	✓	✓	✓
Exchange	✓	✓	✓	
Repair	✓		✓	

\* Including invoice, order number and etc.

Temtop warranty does NOT include:

- Malfunction or damages caused by artificial damage or modification.
- Other deliberate damages.
- Damage caused by natural events.

# *Temtop*

## **Elitech Technology, Inc**

2528 Qume Dr, Ste 2  
San Jose, CA 95131 USA  
Tel: (+1) 408-898-2866  
Facebook: [www.facebook.com/temtopus](http://www.facebook.com/temtopus)  
Instagram: [www.instagram.com/temtopaqm/](http://www.instagram.com/temtopaqm/)  
youtube: [www.youtube.com/@Temtopus](http://www.youtube.com/@Temtopus)  
linkedin: [www.linkedin.com/company/temtop-us/](http://www.linkedin.com/company/temtop-us/)  
X: [x.com/temtopus48285](https://x.com/temtopus48285)  
Sales: [sales@temtopus.com](mailto:sales@temtopus.com)  
Website: [www.temtopus.com](http://www.temtopus.com)

## **Elitech Brazil Ltda**

R.Dona Rosalina,90-Lgara, Canoas-RS  
92410-695,Brazil  
Tel: (+55)51-3939-8634  
Sales: [brasil@e-elitech.com](mailto:brasil@e-elitech.com)  
Website: [www.elitechbrasil.com.br](http://www.elitechbrasil.com.br)

## **Elitech (UK) Limited**

Unit 13 Greenwich Business Park,  
53 Norman Road,London, SE10 9QF  
Tel: (+44)208-858-1888  
Youtube: @elitech\_uk  
Instagram: @elitechuk\_  
Facebook: @hvaccontrol  
Sales: [sales@elitecheu.com](mailto:sales@elitecheu.com)  
Website: [www.temtop.co.uk](http://www.temtop.co.uk)